

**A1** GROUNDING PLAN - GROUND FLOOR - AREA C  
SCALE 1/8" = 1'-0"

**GENERAL SHEET NOTES**

- A. REFER TO SHEET E-001 FOR ABBREVIATIONS, LEGENDS, AND SYMBOLS.
- B. DESIGN SHOWN IS DIAGRAMMATIC AND INTENDED TO SHOW THE GROUNDING ELECTRODE SYSTEM. VERIFY DIMENSIONS, SITE CONDITIONS, AND COORDINATE GROUNDING WITH OTHER UTILITIES.
- C. PROVIDE MAGNETIC TAPE OVER ALL BURIED GROUNDING CONDUCTORS.
- D. GROUNDING SYSTEM TO CONSIST OF 3 GROUND LOOPS SCHEMES THAT ARE TO BE INTERCONNECTED. SEE FOLLOWING:
  - a. EXTERIOR UNDERGROUND GROUNDING LOOP APPROXIMATELY 3' FROM BUILDING.
  - b. EXTERIOR ABOVE GROUND GROUNDING LOOP TO BE MOUNTED ON BUILDING APPROXIMATELY 2' AFG; TO BOND METAL DOORS, METAL WINDOWS, AND METAL UTILITIES.
  - c. INTERIOR GROUNDING LOOP TO BE MOUNTED APPROXIMATELY 18" AFF.; TO BOND INTERIOR BUILDING EQUIPMENT.
- E. GROUND METALLIC PIPES AT TWO LOCATIONS USING AN APPROVED CLAMP WITHIN 5 FEET OF SERVICE ENTRANCE.
- F. BOND ALL METALLIC UNDERGROUND PIPING ENTERING THE STRUCTURE TO THE LIGHTNING PROTECTION SYSTEM AT ITS NEAREST POINT.
- G. LIGHTNING PROTECTION SYSTEM IS A DELEGATED DESIGN AND MUST MEET NFPA 780 AND MASTER LABEL CERTIFICATION.

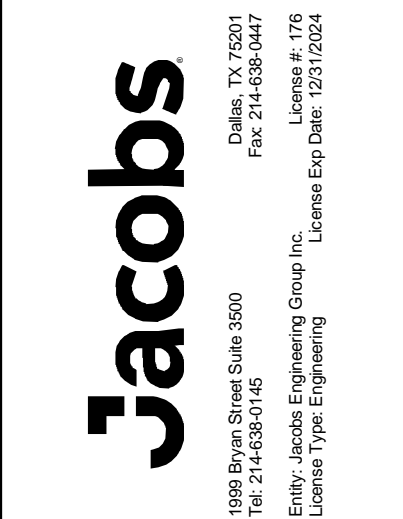

REVISION				BY		DATE		CHK		APP	
1	10/03/2024	ADDENDUM 01 - EXPANSION	100% ISSUED FOR CONSTRUCTION	CJA	AM	CJA	AM				
0	09/18/2024			CJA	AM						
NO.	DATE	REVISION		BY		DATE		CHK		APP	
DSGN				CJA				GN		AM	

GMLRS  
Camden OSD  
Calhoun County, Arkansas  
Aerojet Rocketdyne

ELECTRICAL  
GROUNDING PLAN - AREA C

SHEET NO	EG103
SCALE	As indicated
DATE	09/18/2024
PROJ	D3754502
DWG	UNDERGROUND, GMLRS, ELEC

**KEY PLAN**

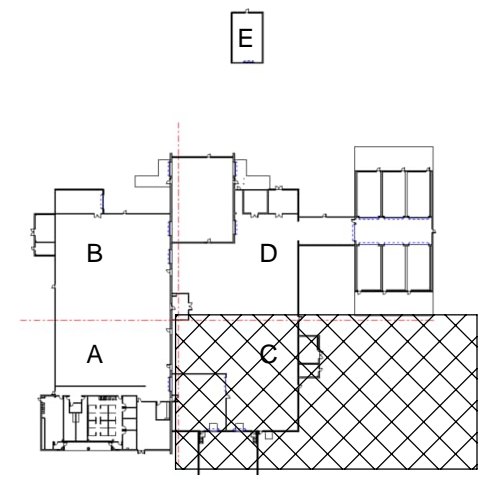

**GRAPHIC SCALE(S)**

