

A1

PARTIAL REFLECTED CEILING PLAN - AREA D

SCALE 1/8" = 1'-0"

GENERAL SHEET NOTES

- A. PROVIDE HOLD-DOWN CLIPS AT ACOUSTICAL CEILING SYSTEM WITHIN 10'-0" OF AN EXTERIOR DOOR.
- B. CENTER LIGHT FIXTURES IN ROOMS; TYP.
- C. CEILINGS ARE AT 10'-0" AFF UNLESS OTHERWISE NOTED
- D. CENTER ACOUSTICAL CEILINGS IN ROOMS, UNLESS OTHERWISE NOTED

SHEET KEYNOTES

83 STL COLUMN - TYPICAL

LEGEND

- PAINTED, MOISTURE RESISTANT GYPSUM BOARD CEILING AS SCHEDULED
- OPEN TO STRUCTURE
- 2'x2' ACOUSTICAL CEILING TILE AS SCHEDULED CENTERED IN SPACE AS INDICATED
- INSULATED METAL PANEL CEILING
- METAL PANEL SOFFIT
- SPRINKLERS, SMOKE DETECTORS, AND SPEAKER STROBES; REFER TO FIRE PROTECTION DRAWINGS.
- LIGHT FIXTURE; REFER TO ELECTRICAL DRAWINGS.
- EXIT LIGHT FIXTURE; REFER TO ELECTRICAL DRAWINGS.
- SUPPLY AIR DIFFUSERS; REFER TO MECHANICAL DRAWINGS.
- RETURN AIR GRILLE; REFER TO MECHANICAL DRAWINGS.

KEY PLAN

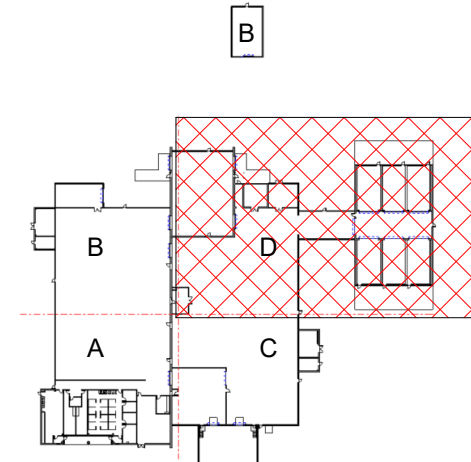

GRAPHIC SCALE(S)

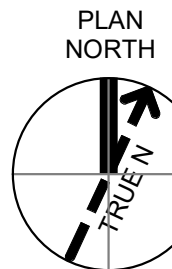

1998 Bryan Street, Suite 2000  
Fort Worth, TX 76102  
Phone: 817.424.4000  
Fax: 817.424.4001  
Email: [info@jacobs.com](mailto:info@jacobs.com)  
License Type: Architecture  
License Exp. Date: 03/31/2025

NO.	DATE	REVISION	CHK.	BY	DATE
0	09/18/2024	100% ISSUED FOR CONSTRUCTION - EXPANSION	DR	MJS	TM
			MB/REP	APVD	TM

GMLRS  
Camden OSD  
Calhoun County, Arkansas  
Aerojet Rocketdyne

ARCHITECTURE  
PARTIAL REFLECTED  
CEILING PLAN  
AREA D

SHEET NO  
A-115

SCALE  
As indicated

DATE  
09/18/2024

PROJ  
D3754502

DWG  
CEM-035\_0001\_A-115

9/18/2024 1:56:25 PM