

## NOTES

### A. GENERAL CONSTRUCTION REQUIREMENTS:

- A1. ALL WORK SHALL BE DONE IN A SAFE AND WORKMANLIKE MANNER AND IN STRICT ACCORDANCE WITH GOVERNING BUILDING CODES, NATIONAL ELECTRIC CODE, AND ALL APPLICABLE REGULATIONS AND ORDINANCES HAVING JURISDICTION.
- A9. THE CONTRACTOR SHALL KEEP THE CONSTRUCTION AREA FREE AND CLEAR OF DEBRIS. REMOVE TRASH AND DEBRIS FROM CONSTRUCTION AREA AND DO NOT ALLOW TO ACCUMULATE. NO FLAMMABLE MATERIALS/LIQUIDS MAY BE STORED IN NEW CONSTRUCTION. PROVIDE EXTINGUISHERS AS REQUIRED BY LOCAL AND STATE AUTHORITIES, UL LISTED 2A:20BC DRY CHEMICAL FIRE EXTINGUISHERS, ACCESSIBLE AT ALL TIMES IN CONSTRUCTION AREAS.
- A14. ALL QUESTIONS RELATING TO THE DEMOLITION OF THIS PROJECT SHALL BE DONE IN WRITTEN FORM THROUGH THE GENERAL CONTRACTOR ONLY.

### B. GENERAL SITE VERIFICATION REQUIREMENTS:

- B1. EXISTING CONDITIONS SHOWN IN THESE PLANS ARE BASED ON LIMITED FIELD OBSERVATIONS BY THE FACILITIES DEPT. AND ORIGINAL DESIGN DRAWINGS. ALL EXISTING MATERIAL, DIMENSIONS, ELEVATIONS, AND GENERAL CONDITIONS OF THE BUILDING SHALL BE VERIFIED BEFORE TO START OF WORK OF THIS CONTRACT. NOTIFY THE PROJECT MANAGER OF ANY DISCREPANCIES BETWEEN PLANS AND FIELD CONDITIONS IMMEDIATELY.
- B2. ALL UTILITY LOCATIONS SHOWN ARE APPROXIMATE. THE CONTRACTOR SHALL FIELD VERIFY THE EXACT LOCATION OF ALL EXISTING UTILITIES (WHETHER SHOWN OR NOT) PRIOR TO THE SUBMISSION OF HIS BID OR THE COMMENCEMENT OF DEMOLITION. THE CONTRACTOR SHALL NOTIFY THE PROJECT MANAGER OF THE DISCOVERY OF EXISTING UTILITIES NOT SHOWN OR NOTED ON DRAWINGS. THE CONTRACTOR SHALL VERIFY EXACT LOCATIONS AND DEPTHS OF UNDERGROUND UTILITY SERVICES PRIOR TO ANY EXCAVATION.
- B3. THE EXISTING BUILDING PROVIDES CRITICAL OPERATIONS. FIBER AND OTHER UNDERGROUND UTILITIES MUST REMAIN PROTECTED AND UNTOUCHED DURING CONSTRUCTION OPERATIONS. GC SHALL COORDINATE WITH AEROJET ENGINEERS TO WORK AROUND THESE ITEMS. GC SHALL LOCATE AND PROTECT ALL EXISTING CRITICAL UTILITIES IN THE AREA OF DEMOLITON & CONSTRUCTION.
- THE EXISTING LIU LOOCATED IN THE OFFICE AS INDICATED ON THE PLANS WILL NEED TO BE PRESERVED ALONG WITH THE FIBER. THE CONTRACTOR SHALL TRACK THE FIBER THROUGH THE BUILDING, LOCATE WHERE THE FIBER GOES UNDERGROUND AND PROTECT THE FIBER AND LIU THROUGHOUT DEMO TO BE RE-USED FOR THE PROPOSED NEW CONTROL ROOM BUILDING.

### D. GENERAL DEMOLITION REQUIREMENTS:

- GENERAL: DEMOLITION OF THE EXISTING A17 CONTROL BUILDING IS A PART OF THIS SCOPE OF WORK. THE BUILDING IS SINGLE STORY AND APPX. 3,000 S.F. A HAZARDOUS MATERIAL SURVEY WILL BE PROVIDED BY THE OWNER. ALL REGULATED HAZARDOUS MATERIALS SHALL BE ABATED & DISPOSED OF PER STATE AND FEDERAL REGULATIONS AS A PART OF THE GENERAL CONTRACTORS SCOPE OF WORK.
- D1. ALL DEMOLITION SHALL BE CARRIED OUT IN A SAFE MANNER AND IN STRICT ACCORDANCE WITH OSHA REGULATIONS.
- D2. THE CONTRACTOR SHALL DEMOLISH THE EXISTING BUILDING IN ITS ENTIRETY AND INCLUDES, MECHANICAL AND ELECTRICAL EQUIPMENT.
- D3. WHEN UTILITIES ARE REMOVED, CAP, SEAL A LABEL.
- D4. IT IS THE CONTRACTOR'S RESPONSIBILITY TO PROVIDE ADEQUATE SHORING, BRACING AND SUPPORT SYSTEMS FOR EXISTING STRUCTURE AND TO KEEP THE EXISTING STRUCTURE INTACT AND IN A SAFE CONDITION DURING DEMOLITION AND NEW CONSTRUCTION. THE CONTRACTOR SHALL RETAIN A REGISTERED PROFESSIONAL ENGINEER TO DESIGN THE SHORING OR BRACING AND SPECIFY DEMOLITION PROCEDURES. IT IS THE CONTRACTOR'S RESPONSIBILITY FOR MEANS AND METHODS OF DEMOLITION AND NEW CONSTRUCTION.
- D5. DURING DEMOLITION AND RECONSTRUCTION, THE CONTRACTOR SHALL COORDINATE WITH THE OWNER ANY REQUIRED SAFETY BARRIERS OR BARRICADES. PROVIDE BARRICADES SO AS TO PRECLUDE INTRUSION OF PUBLIC INTO CONSTRUCTION AREAS.
- D6. CONTRACTOR SHALL PROVIDE THE OWNER A CONSTRUCTION PHASING SCHEDULE FOR DEMOLITION AND NEW CONSTRUCTION. COORDINATE DEMOLITION WITH NEW CONSTRUCTION SO THE CAMPUS WILL HAVE LIMITED INTERRUPTION OF WATER, SEWER, ELECTRICAL, GAS AND FIRE PROTECTION SERVICE. THE CONTRACTOR IS RESPONSIBLE FOR MAKING ALL NECESSARY TEMPORARY UTILITY PROVISIONS REQUIRED.
- D7. ALL DEMOLITION MATERIALS NOT SALVAGED BY THE OWNER SHALL BE REMOVED BY THE CONTRACTOR. COORDINATE WITH THE OWNER REGARDING MATERIALS TO BE SALVAGED. ALL DEMOLISHED MATERIALS LEAVING THE SITE SHALL BE DOCUMENTED. A MANIFEST OF ITEMS REMOVED FROM THE SITE IS REQUIRED TO BE SUBMITTED TO THE OWNER'S PROJECT MANAGER.
- D8. REMOVE EXISTING RESILIENT FLOORING SYSTEM AT EXISTING BUILDING FLOOR AREAS AND REPAIR CONCRETE SUBSTRATE FOR NEW FLOORING SYSTEM.
- D9. REFER TO MECHANICAL, PLUMBING, FIRE PROTECTION, AND ELECTRICAL DRAWINGS FOR NECESSARY FLOOR SLAB DEMOLITION FOR THE INSTALLATION OF NEW PIPING OR CONDUITS.
- D10. THE CONTRACTOR SHALL USE A WET SAW FOR SLAB SAWING. NO JACK HAMMERS WILL BE ALLOWED WITHOUT PRIOR APPROVAL FROM THE OWNER. REMOVE EXISTING CERAMIC TILE/QUARRY TILE AT AREAS TO RECEIVE NEW FLOOR FINISH. PREPARE CONCRETE SUBSTRATE, CEMENT GROUT INFILL DEPRESSED AREAS. FLUSH AND LEVEL FOR NEW FLOOR FINISH FOR SMOOTH TRANSITION TO ADJACENT FLOOR AREAS.
- D11. PROTECT ALL WATER PIPING AT AREAS OF DEMOLITION, EXPANSION AND REMODEL, WHERE EXISTING PIPING IS SUBJECT TO FREEZING. PROTECT PIPING SO AS NOT TO FREEZE.
- D12. CONTRACTOR SHALL DISPOSE OF ALL WASTE AND BE RESPONSIBLE FOR ALL FEES ASSOCIATED WITH DISPOSAL. CONTRACTOR SHALL PROVIDE OWNER WITH A MANIFEST FOR ALL ITEMS THAT HAVE BEEN TAKEN OFF SITE FOR DISPOSAL.

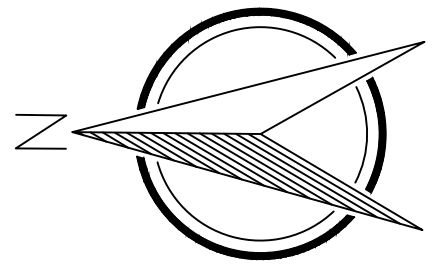
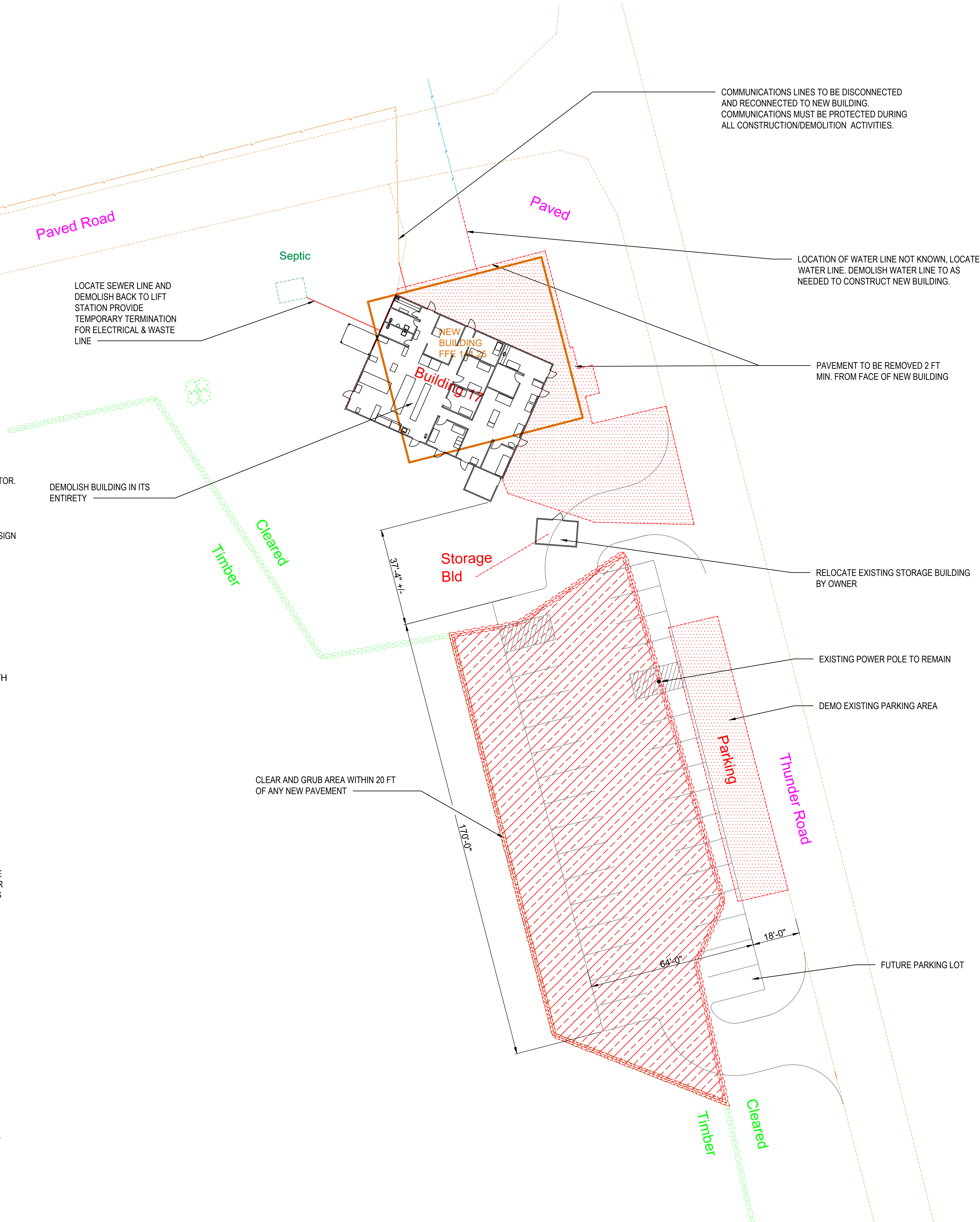

**AEROJET  
ROCKETDYNE**  
An L3Harris Technologies Company

DEMO EXISTING BUILDING A17

ARKANSAS

EAST CAMDEN,

PROJECT MANAGER:  
PHILIP BORZILLO

BUILDING MANAGER:  
JAMES "TIMY" HOPKINS

SAFETY:  
JIMMY NEIL

DRAWN BY:  
PHILIP BORZILLO

CHECKED BY:  
JERRY ATCHISON

DATE:  
MARCH 6, 2025

**D1**

FOR BID PURPOSES ONLY